

GENERAL NOTES

1. THIS PLAN IS THE PROPERTY OF THE ENGINEER AND IS NOT TO BE REPRODUCED OR COPIED IN ANY MANNER WITHOUT HIS WRITTEN CONSENT.
2. THE ENGINEER HAS CONDUCTED A VISUAL SURVEY OF THE SITE AND HAS FOUND IT TO BE SUITABLE FOR THE PROPOSED DEVELOPMENT.
3. THE ENGINEER HAS CONDUCTED A VISUAL SURVEY OF THE SITE AND HAS FOUND IT TO BE SUITABLE FOR THE PROPOSED DEVELOPMENT.
4. THE ENGINEER HAS CONDUCTED A VISUAL SURVEY OF THE SITE AND HAS FOUND IT TO BE SUITABLE FOR THE PROPOSED DEVELOPMENT.
5. THE ENGINEER HAS CONDUCTED A VISUAL SURVEY OF THE SITE AND HAS FOUND IT TO BE SUITABLE FOR THE PROPOSED DEVELOPMENT.
6. THE ENGINEER HAS CONDUCTED A VISUAL SURVEY OF THE SITE AND HAS FOUND IT TO BE SUITABLE FOR THE PROPOSED DEVELOPMENT.
7. THE ENGINEER HAS CONDUCTED A VISUAL SURVEY OF THE SITE AND HAS FOUND IT TO BE SUITABLE FOR THE PROPOSED DEVELOPMENT.
8. THE ENGINEER HAS CONDUCTED A VISUAL SURVEY OF THE SITE AND HAS FOUND IT TO BE SUITABLE FOR THE PROPOSED DEVELOPMENT.
9. THE ENGINEER HAS CONDUCTED A VISUAL SURVEY OF THE SITE AND HAS FOUND IT TO BE SUITABLE FOR THE PROPOSED DEVELOPMENT.
10. THE ENGINEER HAS CONDUCTED A VISUAL SURVEY OF THE SITE AND HAS FOUND IT TO BE SUITABLE FOR THE PROPOSED DEVELOPMENT.
11. THE ENGINEER HAS CONDUCTED A VISUAL SURVEY OF THE SITE AND HAS FOUND IT TO BE SUITABLE FOR THE PROPOSED DEVELOPMENT.
12. THE ENGINEER HAS CONDUCTED A VISUAL SURVEY OF THE SITE AND HAS FOUND IT TO BE SUITABLE FOR THE PROPOSED DEVELOPMENT.
13. THE ENGINEER HAS CONDUCTED A VISUAL SURVEY OF THE SITE AND HAS FOUND IT TO BE SUITABLE FOR THE PROPOSED DEVELOPMENT.
14. THE ENGINEER HAS CONDUCTED A VISUAL SURVEY OF THE SITE AND HAS FOUND IT TO BE SUITABLE FOR THE PROPOSED DEVELOPMENT.
15. THE ENGINEER HAS CONDUCTED A VISUAL SURVEY OF THE SITE AND HAS FOUND IT TO BE SUITABLE FOR THE PROPOSED DEVELOPMENT.
16. THE ENGINEER HAS CONDUCTED A VISUAL SURVEY OF THE SITE AND HAS FOUND IT TO BE SUITABLE FOR THE PROPOSED DEVELOPMENT.
17. THE ENGINEER HAS CONDUCTED A VISUAL SURVEY OF THE SITE AND HAS FOUND IT TO BE SUITABLE FOR THE PROPOSED DEVELOPMENT.
18. THE ENGINEER HAS CONDUCTED A VISUAL SURVEY OF THE SITE AND HAS FOUND IT TO BE SUITABLE FOR THE PROPOSED DEVELOPMENT.
19. THE ENGINEER HAS CONDUCTED A VISUAL SURVEY OF THE SITE AND HAS FOUND IT TO BE SUITABLE FOR THE PROPOSED DEVELOPMENT.
20. THE ENGINEER HAS CONDUCTED A VISUAL SURVEY OF THE SITE AND HAS FOUND IT TO BE SUITABLE FOR THE PROPOSED DEVELOPMENT.

FINAL LAND DEVELOPMENT PLAN
INDEPENDENCE DOGS, INC.
 STATE LINE ROAD
 BETHEL TOWNSHIP BELLAIR COUNTY
 PENNSYLVANIA
 SCALE 1" = 40'
 DATE: MAY 22, 1998

MANDEMARK & WASHING, INC.
 ENGINEERS
 1700 S. 10TH ST.
 PITTSBURGH, PA 15203
 PHONE: 412-261-1111
 FAX: 412-261-1112

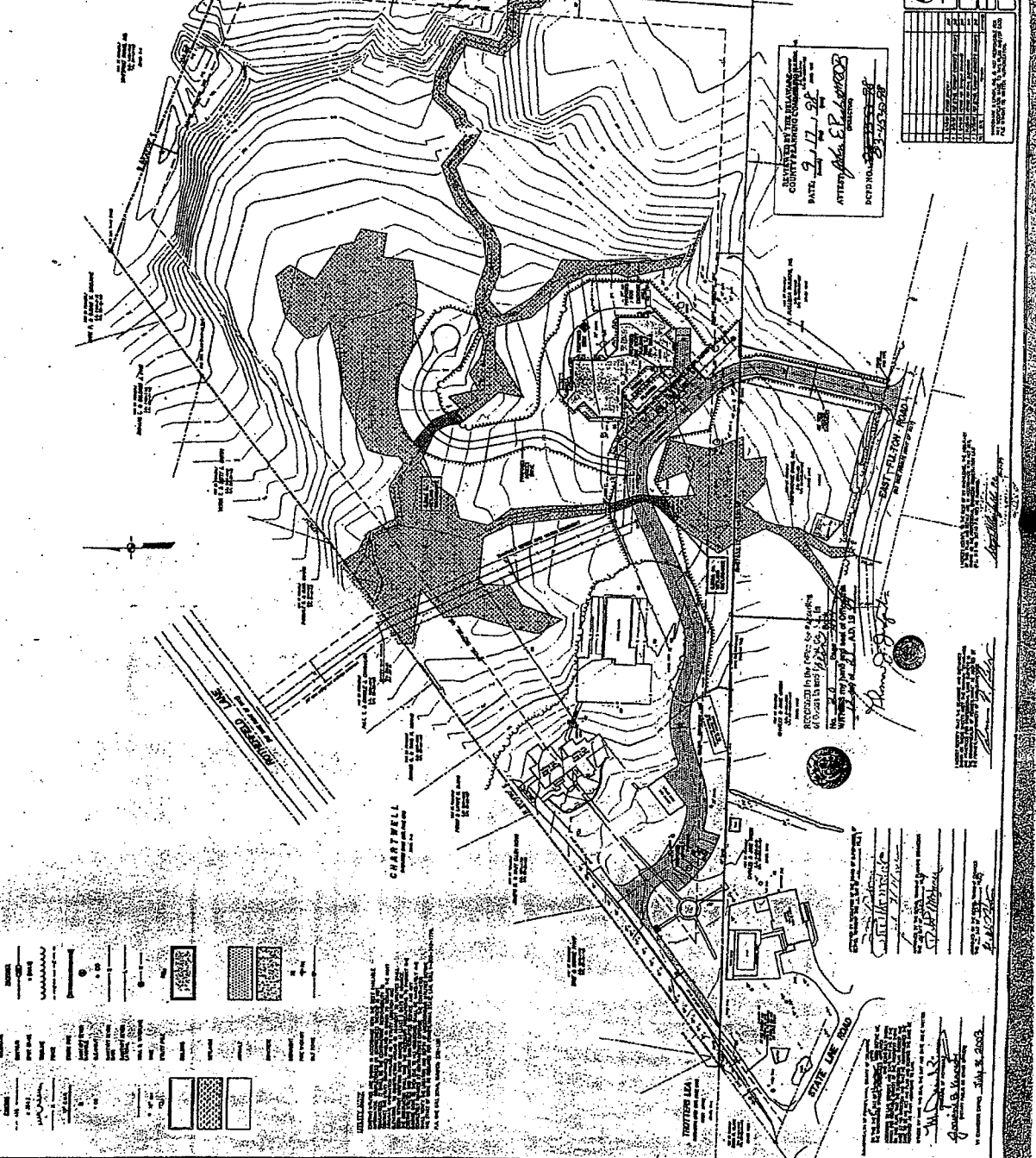

LEGEND

PROPOSED DRIVEWAY	EXISTING DRIVEWAY
PROPOSED SIDEWALK	EXISTING SIDEWALK
PROPOSED PAVEMENT	EXISTING PAVEMENT
PROPOSED CONCRET	EXISTING CONCRET
PROPOSED ASPHALT	EXISTING ASPHALT
PROPOSED GRAVEL	EXISTING GRAVEL
PROPOSED SAND	EXISTING SAND
PROPOSED CLAY	EXISTING CLAY
PROPOSED SILT	EXISTING SILT
PROPOSED SAND & SILT	EXISTING SAND & SILT
PROPOSED SAND & CLAY	EXISTING SAND & CLAY
PROPOSED SAND & SILT & CLAY	EXISTING SAND & SILT & CLAY
PROPOSED SAND & SILT & CLAY & GRAVEL	EXISTING SAND & SILT & CLAY & GRAVEL
PROPOSED SAND & SILT & CLAY & GRAVEL & ASPHALT	EXISTING SAND & SILT & CLAY & GRAVEL & ASPHALT
PROPOSED SAND & SILT & CLAY & GRAVEL & ASPHALT & CONCRETE	EXISTING SAND & SILT & CLAY & GRAVEL & ASPHALT & CONCRETE

DESIGNED BY: THE ENGINEER
 DATE: 5/12/98
 ATTORNEY: E. P. ...
 REFERENCE: ...

CHARTWELL

NOTES

1. THE ENGINEER HAS CONDUCTED A VISUAL SURVEY OF THE SITE AND HAS FOUND IT TO BE SUITABLE FOR THE PROPOSED DEVELOPMENT.
2. THE ENGINEER HAS CONDUCTED A VISUAL SURVEY OF THE SITE AND HAS FOUND IT TO BE SUITABLE FOR THE PROPOSED DEVELOPMENT.
3. THE ENGINEER HAS CONDUCTED A VISUAL SURVEY OF THE SITE AND HAS FOUND IT TO BE SUITABLE FOR THE PROPOSED DEVELOPMENT.
4. THE ENGINEER HAS CONDUCTED A VISUAL SURVEY OF THE SITE AND HAS FOUND IT TO BE SUITABLE FOR THE PROPOSED DEVELOPMENT.
5. THE ENGINEER HAS CONDUCTED A VISUAL SURVEY OF THE SITE AND HAS FOUND IT TO BE SUITABLE FOR THE PROPOSED DEVELOPMENT.
6. THE ENGINEER HAS CONDUCTED A VISUAL SURVEY OF THE SITE AND HAS FOUND IT TO BE SUITABLE FOR THE PROPOSED DEVELOPMENT.
7. THE ENGINEER HAS CONDUCTED A VISUAL SURVEY OF THE SITE AND HAS FOUND IT TO BE SUITABLE FOR THE PROPOSED DEVELOPMENT.
8. THE ENGINEER HAS CONDUCTED A VISUAL SURVEY OF THE SITE AND HAS FOUND IT TO BE SUITABLE FOR THE PROPOSED DEVELOPMENT.
9. THE ENGINEER HAS CONDUCTED A VISUAL SURVEY OF THE SITE AND HAS FOUND IT TO BE SUITABLE FOR THE PROPOSED DEVELOPMENT.
10. THE ENGINEER HAS CONDUCTED A VISUAL SURVEY OF THE SITE AND HAS FOUND IT TO BE SUITABLE FOR THE PROPOSED DEVELOPMENT.
11. THE ENGINEER HAS CONDUCTED A VISUAL SURVEY OF THE SITE AND HAS FOUND IT TO BE SUITABLE FOR THE PROPOSED DEVELOPMENT.
12. THE ENGINEER HAS CONDUCTED A VISUAL SURVEY OF THE SITE AND HAS FOUND IT TO BE SUITABLE FOR THE PROPOSED DEVELOPMENT.
13. THE ENGINEER HAS CONDUCTED A VISUAL SURVEY OF THE SITE AND HAS FOUND IT TO BE SUITABLE FOR THE PROPOSED DEVELOPMENT.
14. THE ENGINEER HAS CONDUCTED A VISUAL SURVEY OF THE SITE AND HAS FOUND IT TO BE SUITABLE FOR THE PROPOSED DEVELOPMENT.
15. THE ENGINEER HAS CONDUCTED A VISUAL SURVEY OF THE SITE AND HAS FOUND IT TO BE SUITABLE FOR THE PROPOSED DEVELOPMENT.
16. THE ENGINEER HAS CONDUCTED A VISUAL SURVEY OF THE SITE AND HAS FOUND IT TO BE SUITABLE FOR THE PROPOSED DEVELOPMENT.
17. THE ENGINEER HAS CONDUCTED A VISUAL SURVEY OF THE SITE AND HAS FOUND IT TO BE SUITABLE FOR THE PROPOSED DEVELOPMENT.
18. THE ENGINEER HAS CONDUCTED A VISUAL SURVEY OF THE SITE AND HAS FOUND IT TO BE SUITABLE FOR THE PROPOSED DEVELOPMENT.
19. THE ENGINEER HAS CONDUCTED A VISUAL SURVEY OF THE SITE AND HAS FOUND IT TO BE SUITABLE FOR THE PROPOSED DEVELOPMENT.
20. THE ENGINEER HAS CONDUCTED A VISUAL SURVEY OF THE SITE AND HAS FOUND IT TO BE SUITABLE FOR THE PROPOSED DEVELOPMENT.

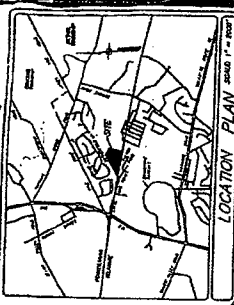

GENERAL NOTES

1. ALL CONSTRUCTION SHALL BE IN ACCORDANCE WITH THE LATEST EDITIONS OF THE NATIONAL BUILDING CODE AND ALL LOCAL ORDINANCES.
2. THE DEVELOPER SHALL BE RESPONSIBLE FOR OBTAINING ALL NECESSARY PERMITS AND APPROVALS FROM THE APPROPRIATE AGENCIES.
3. THE UTILITIES SHOWN ON THIS PLAN ARE BASED ON RECORD DRAWINGS AND FIELD SURVEY. THE DEVELOPER SHALL VERIFY THE LOCATION AND DEPTH OF ALL UTILITIES PRIOR TO CONSTRUCTION.
4. THE PROPOSED ROADS SHALL BE CONSTRUCTED TO MEET THE REQUIREMENTS OF THE NORTH CAROLINA ROAD DESIGN MANUAL.
5. THE PROPOSED UTILITIES SHALL BE INSTALLED IN ACCORDANCE WITH THE REQUIREMENTS OF THE NORTH CAROLINA UTILITIES CODE.
6. THE PROPOSED CONSTRUCTION SHALL BE COMPLETED WITHIN THE SPECIFIED TIME FRAME.
7. THE DEVELOPER SHALL MAINTAIN ACCESS TO ALL ADJACENT PROPERTIES AT ALL TIMES.
8. THE PROPOSED CONSTRUCTION SHALL BE SUBJECT TO THE APPROVAL OF THE LOCAL GOVERNMENT AND THE STATE DEPARTMENT OF TRANSPORTATION.
9. THE DEVELOPER SHALL BE RESPONSIBLE FOR THE PROTECTION OF ALL EXISTING UTILITIES AND STRUCTURES.
10. THE PROPOSED CONSTRUCTION SHALL BE SUBJECT TO THE REQUIREMENTS OF THE FEDERAL AND STATE ENVIRONMENTAL LAWS.

SHEET INDEX

SHEET 1 OF 3 LAND DEVELOPMENT PLAN
 SHEET 2 OF 3 CONSTRUCTION PLAN
 SHEET 3 OF 3 DETAIL SHEET

FINAL LAND DEVELOPMENT PLAN
 FOR
INDEPENDENCE DOGS, INC.
 STATE LINE ROAD
 BETHEL TOWNSHIP, DEWARHE COUNTY
 NORTH CAROLINA
 SOLD 1" = 40' JULY 23, 1989

LANDMARK SURVEYING & ENGINEERING, INC.	
NO. 1000	PLANNING & ENGINEERING
1000 S. W. 10th Street, Tallahassee, Florida 32302	
DATE	JULY 23, 1989
BY	[Signature]
CHECKED BY	[Signature]
SCALE	1" = 40'
THIS DRAWING IS THE PROPERTY OF LANDMARK SURVEYING & ENGINEERING, INC. IT IS TO BE USED ONLY FOR THE PROJECT AND SITE SPECIFICALLY IDENTIFIED HEREON. IT IS NOT TO BE REPRODUCED, COPIED, OR TRANSMITTED IN ANY FORM OR BY ANY MEANS, ELECTRONIC OR MECHANICAL, INCLUDING PHOTOCOPYING, RECORDING, OR BY ANY INFORMATION STORAGE AND RETRIEVAL SYSTEM, WITHOUT THE WRITTEN PERMISSION OF LANDMARK SURVEYING & ENGINEERING, INC.	

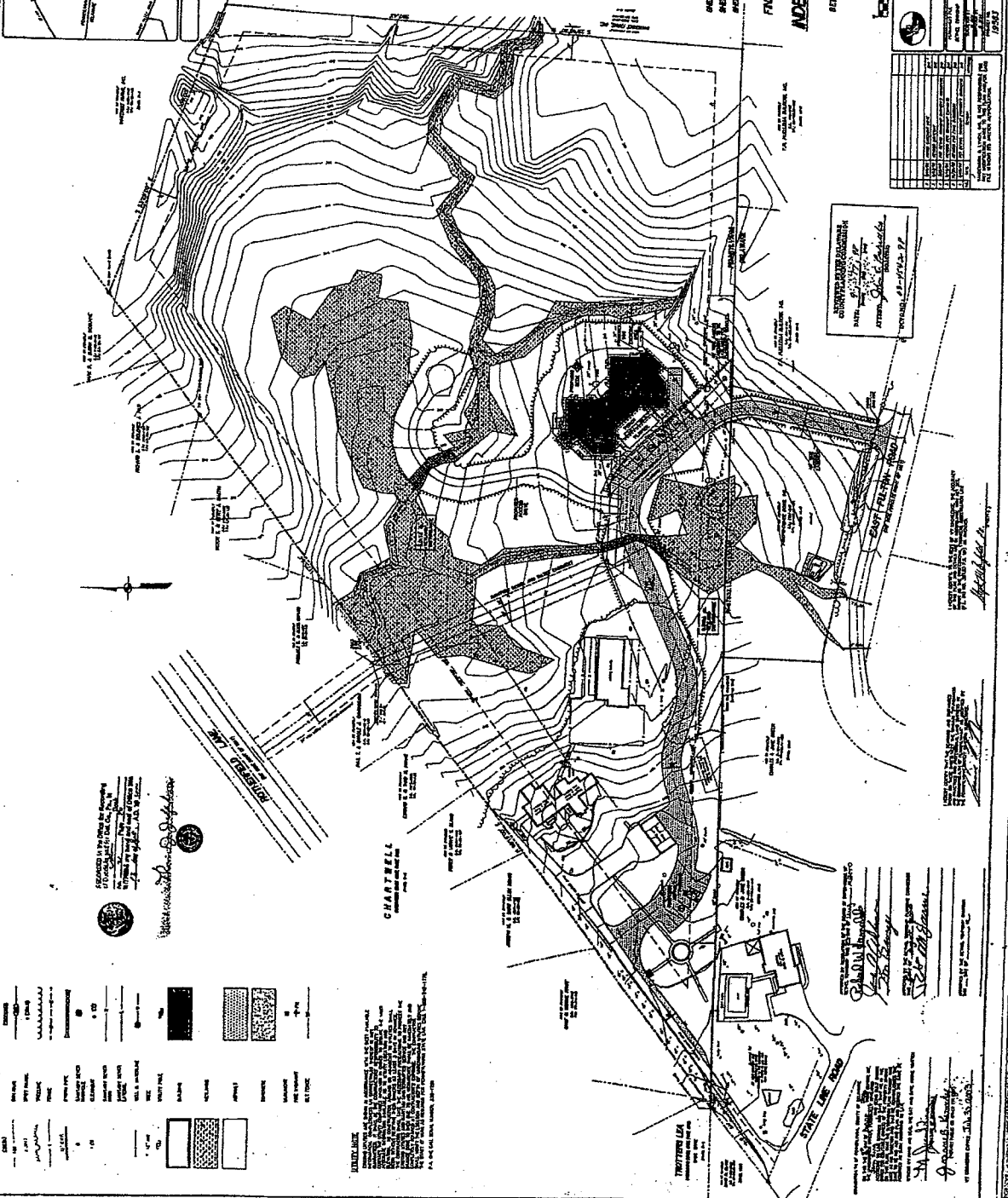

LEGEND

EXISTING	PROPOSED
ROAD	ROAD
UTILITY	UTILITY
...	...

CHARTWELL
 ENGINEER

STATE LINE ROAD
 [Signatures and stamps]